

BUILD A DREAM Fabulous Farmhouse



1,601 square feet

HMAFAPW01301 Details:

- ◆ Bedrooms: 3
- ◆ Baths: 2
- ◆ Main floor: 1,601 sq. ft.
- ◆ Total Living Area: 1,601 sq. ft.
- ◆ Standard Basement: 1,601 sq. ft.
- ◆ Exterior Wall Framing: 2x6

A beautiful wraparound porch takes full advantage of 360-degree views.

Looking for a classic country home with room for rocking chairs on the porch? Plan HMAFAPW01301 from Homeplans.com delivers graceful curb appeal.

Head inside, and you will be greeted by 1,601 square feet of well-planned living area. Formal spaces – the living and dining rooms – are positioned on the left and sleeping quarters to the right.

Windows and a fireplace make the living room a comfortable, bright hangout. The dining room opens with French doors to the porch, and leads directly into the kitchen for easy serving.

A small island in the kitchen offers extra countertop for food preparation. This space overlooks the breakfast nook, which sits in a beautiful bay window and opens to the porch.

The laundry room is nearby, making it easy to transfer a load while keeping an eye on the stovetop.

In the bedroom wing, the master suite enjoys French doors to the porch, a wall of closet space, and a private bath. Two family bedrooms share a full hall bath.

With living spaces on one end and sleeping quarters on the other, this design offers quiet at bedtime.

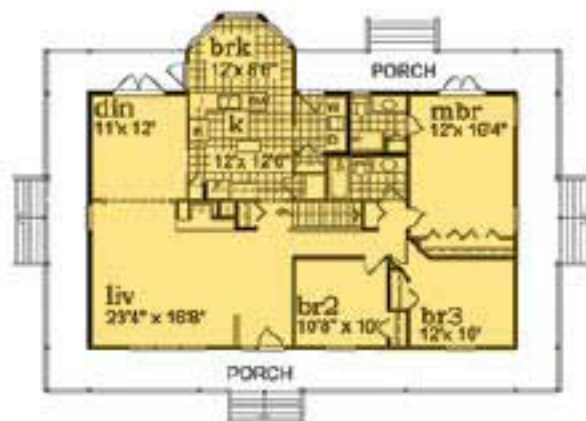

A downloadable study plan of this house, Plan HMAFAPW01301, including general information on building costs and financing, is available at www.houseoftheweek.com. To receive a study plan by mail, include a check or money order for \$10, plus state and local sales tax, payable to House of the Week. Mail to: Harley Wood, 3275 W. Ina Rd., Suite 260, Tucson, AZ 85741. Be sure to reference the plan number. To view hundreds of home designs, visit www.houseoftheweek.com.

Associated Press