

# Smart Storage, Relaxed Living

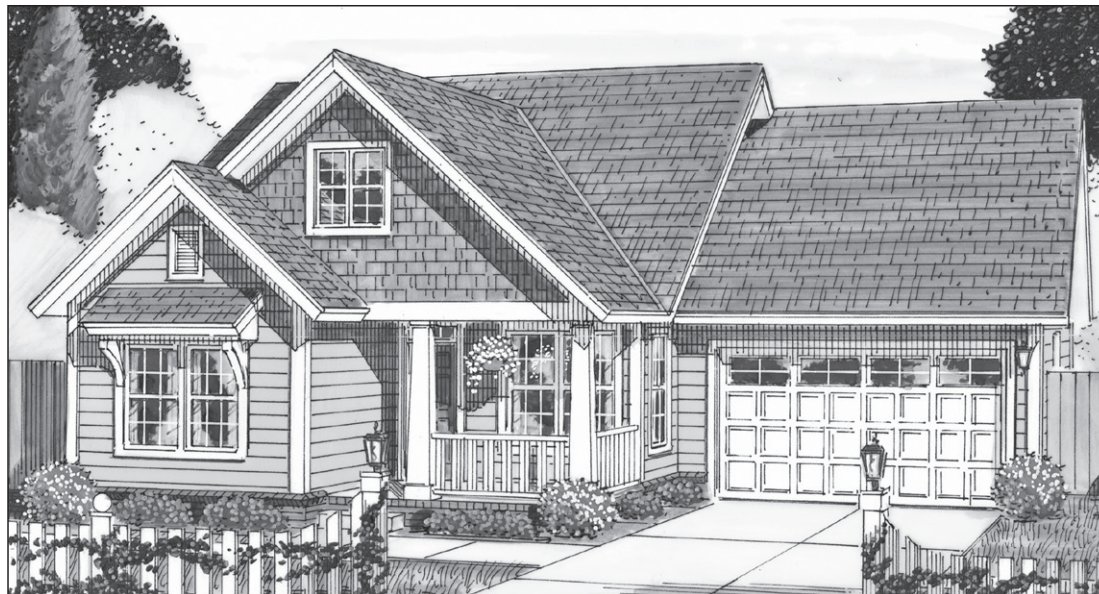

A sweet entry porch and set-back garage add appeal this compact design.

## 1,810 square feet

HOTW140004 Details

- **Bedrooms:** 3
- **Baths:** 2
- **Dimensions:** 52'0" x 65'10"
- **Exterior Wall Framing:** 2x4
- **Foundation Options:** Slab

There's more storage than you'd expect, especially in the garage, the master suite, and the kitchen's pantry. Here's a home that fills the need for great storage. After parking in the three-car tandem garage, enter into the mud room area next to the spacious laundry room (no need to walk through it) and drop boots in the closet and groceries in the kitchen. The kitchen offers a walk-in pantry, a central island with a snack bar, and another counter that overlooks the living room. Want space to work from home or pursue hobbies? The study is ready. Book shelves line the way to the surprisingly roomy master suite, where a very large walk-in closet, big shower, separate tub, and two sinks invite relaxation. Two more bedrooms share a hall bath.

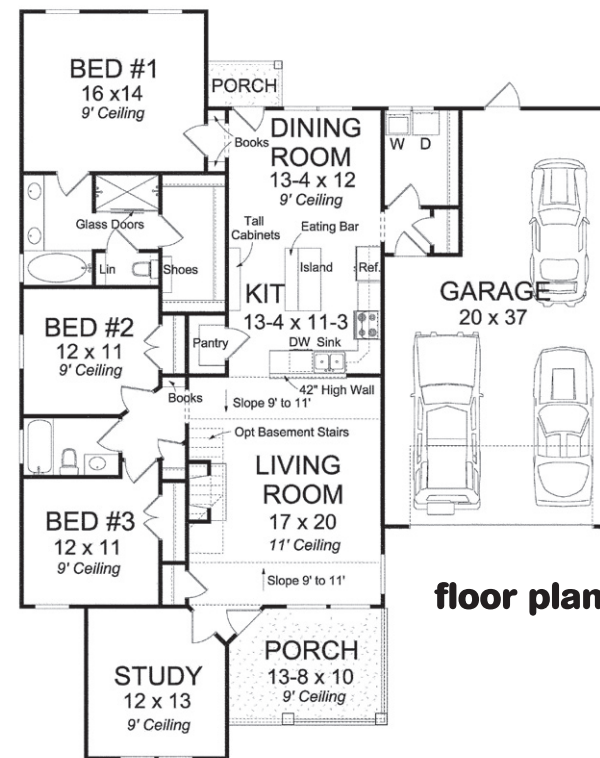

**floor plan**