

B U I L D A D R E A M

Classic Home with a Fresh Layout



Traditional brick gives a stately appearance to this two-story home. Note the lovely sidelights around the entrance.

To build this home, you can order a complete set of construction documents by calling toll-free (866) 772-1013 or visiting www.ePlans.com/HouseOfTheWeek. You can view previously featured plans, browse other specialty collections, or use our search filters to help you find exactly what you want from over 28,000 home designs. Most plans can be customized to suit your lifestyle. See images of the plan online at www.ePlans.com/HouseOfTheWeek. Image Credit: *Image Credit: © www.ePlans.com. Printed with permission by Hanley-Wood, LLC. All rights reserved.

2,487 square feet

HOTW140026 Details

- **Bedrooms:** 4
- **Baths:** 3
- **Main Level:** 2,019 sq. ft.
- **Upstairs Level:** 468 sq. ft.
- **Bonus Space:** 286 sq. ft.
- **Dimensions:** 59'0" x 58'0"
- **Exterior Wall Framing:** 2x4

floor plan

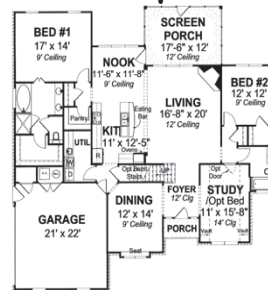

second floor plan

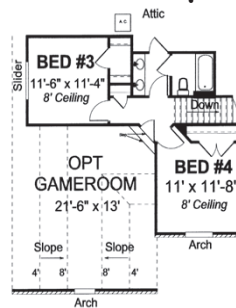

This attractive home features a modern open layout with lots of flexibility. For example, the study on the first floor could be closed off to become an easily accessed fifth bedroom (an optional door gives it access to the hall bath). The master suite also sits on this floor (convenient for aging in place) and invites you to relax in its spacious window-side tub and separate shower. Upstairs, you'll find an optional game room, two more bedrooms, and a bath. A snack-bar island anchors the kitchen and easily serves the breakfast nook and dining room. The rear screened porch makes outdoor meals a possibility.